



**Ministry of Public Works
Department of Works and Engineering**

**Request for Proposals
For
Asphalt Plant Site Works
ADDENDUM 3**

Request for Proposals No.: **PN/2024-002-Q-AP**

Issued: **Thursday August 29, 2024**

Submission Deadline: **Friday September 6, 2024 03:00:00 PM** Bermuda Local Time

ADDENDUM 3

1. The RFP Timetable has **not** been changed from Addenda #1.
2. Please note that the design continues to be defined but the bill of materials for the anchor bolts and other embeds **will not** be available prior to the tender closing. Please prepare your bill of materials to bid the project accordingly.
3. Please note that the Pricing Form has been revised, attached and this is the Pricing Form to be submitted with your tender response.
4. The Site Grading line item has been converted to an **Allowance Item** to be used to complete the site excavation, backfilling, compaction and fine grading. This change is to allow each bidder to prepare a complete bid while the final site grading design is being fully define and completed.
5. Sketch, SK-01 is attached which tries to show the extent of the grading for this project and an approximate volume of fill to be placed.
6. Item 3 has been broken down into the works required for each foundation as defined by the work on the drawings.
7. Do not price for the 2" concrete blinding layer shown on some drawings. It is expected that the rebar will be supported on chairs sitting on firm granular material. If this is not the case, a change order will be issued at that time.
8. Drawing S-303 Revision 0, attached, the base slab and the walls will be 6" thick, and the slab shall be 25 feet long and 10 feet wide, out to out, or 9 feet clear between walls.

FIXED PRICE SCHEDULE

CONTRACT PRICE BREAKDOWN

(TO BE COMPLETED BY THE PROPONENT)

All prices (in Bermuda dollars) are to be all inclusive of all other associated works as shown on the Contract Documents, including materials, related accessories, storage, transport, assembly, placement, coordination w/ MPW, and overhead and profit. These rates may be used for determining additions and deletions from the contract sum and for interim payment valuation.

ITEM	DESCRIPTION	LUMP SUM
1.0	Mobilization	
2.0	Allowance for all Site Grading, Excavation, Backfilling and Compaction	\$70, 000.00
3.0	Concrete Foundations, scope of work is shown on each drawing	
3.1	Storage Silo Foundation per Astec drawings F24-090-02 and 03.	
3.2	Dryer/Tower per Astec drawings F24-090-04, 05, 06, 07 and 08.	
3.3	Cold Feed Bins per Astec drawings F24-090-09, 10 and 11.	
3.4	Control Cabin per Astec drawings F24-090-12.	
3.5	Bitumen Tank per Astec drawings F24-090-13 and 14.	
3.6	Screening Plant Foundations per iEPC drawings S-001, S-100, S-101, S-102, S-200, S-300, S-301 and S-302.	
3.7	Asphalt release agent area per iEPC drawings S-001, S-303, and Brick Verde drawing MEP1.2.	
4.0	Chain Link Fencing/Gates	
5.0	Electrical Conduit Supply and Installation in Foundations	
6.0	Refurbish BELCO Vault to Asphalt Laboratory	
7.0	Demobilization and Site Clean-up	
	TOTAL FIXED PRICE	

NOTE: All work detailed on the Contract Documents shall be covered completely by the Total Lump Sum. Individual lump sum items are all-inclusive. If a specific task is not identified separately in the above list, the Contractor shall assume that it is included as part of another related listed item or items, and shall base his lump sum amounts on this assumption. The price shall include, indicate separately, the cost of any work permits, and taxes.

UNIT RATE SCHEDULE

(TO BE COMPLETED BY THE CONTRACTOR)

All prices (in Bermuda dollars) in the schedule are to be inclusive of materials, tools and related accessories, storage, transport, plant and equipment (staging, platforms etc. to work on deck edge) assembly, placement, access, wastage, coordination with MPW and overhead and profit. These rates may be used for determining additions to, and deletions from, the contract sum.

ITEM	DESCRIPTION	Unit	Rate
1.	Site Supervisor	per hour	
2.	Skilled Labour	per hour	
3.	Unskilled Labour	per hour	
4.	Welder / Steel work	per hour	
5.	Mason	per hour	
6.	Crane	per hour	
7.	Trucking	per hour	
8.	30mm dia. Anchor bolt, nuts and washer (other sizes to be pro-rated)	Ea.	
9.	#4 rebar, 20ft length	Ea.	
10.	#6 rebar, 20ft length	Ea.	
11.	#8 rebar, 20ft length	Ea.	
12.	PVC Dumbbell water stop	Ft.	
13.	4000 psi concrete, formwork, placed, consolidated, finished and cured		
14.	Excavator		
15.	Compaction equipment		
Other items not listed above			

All unit rates above shall be considered fully inclusive of labour, materials, tools, and equipment, wastage and overheads and profit, including, delivery, storage, preparation, placing and finishing.

For variations to the contract not covered in the preceding price break down rates or the above schedule of unit rates, the price may be determined on the basis of the base material and installation cost plus _____% for overhead and _____% for profit and applied separately to the base cost.

Addenda 3 - SK-01

Approximate area, to be graded and filled with existing materials stock piled on site. The red line is the toe of the slope, the light blue is the top of slope and the next area is a flat 5ft wide area around the foundations. Some excavation will be required under the Silo and Control Cabin.

This work is covered in the Allowance in the Fixed Price Table.

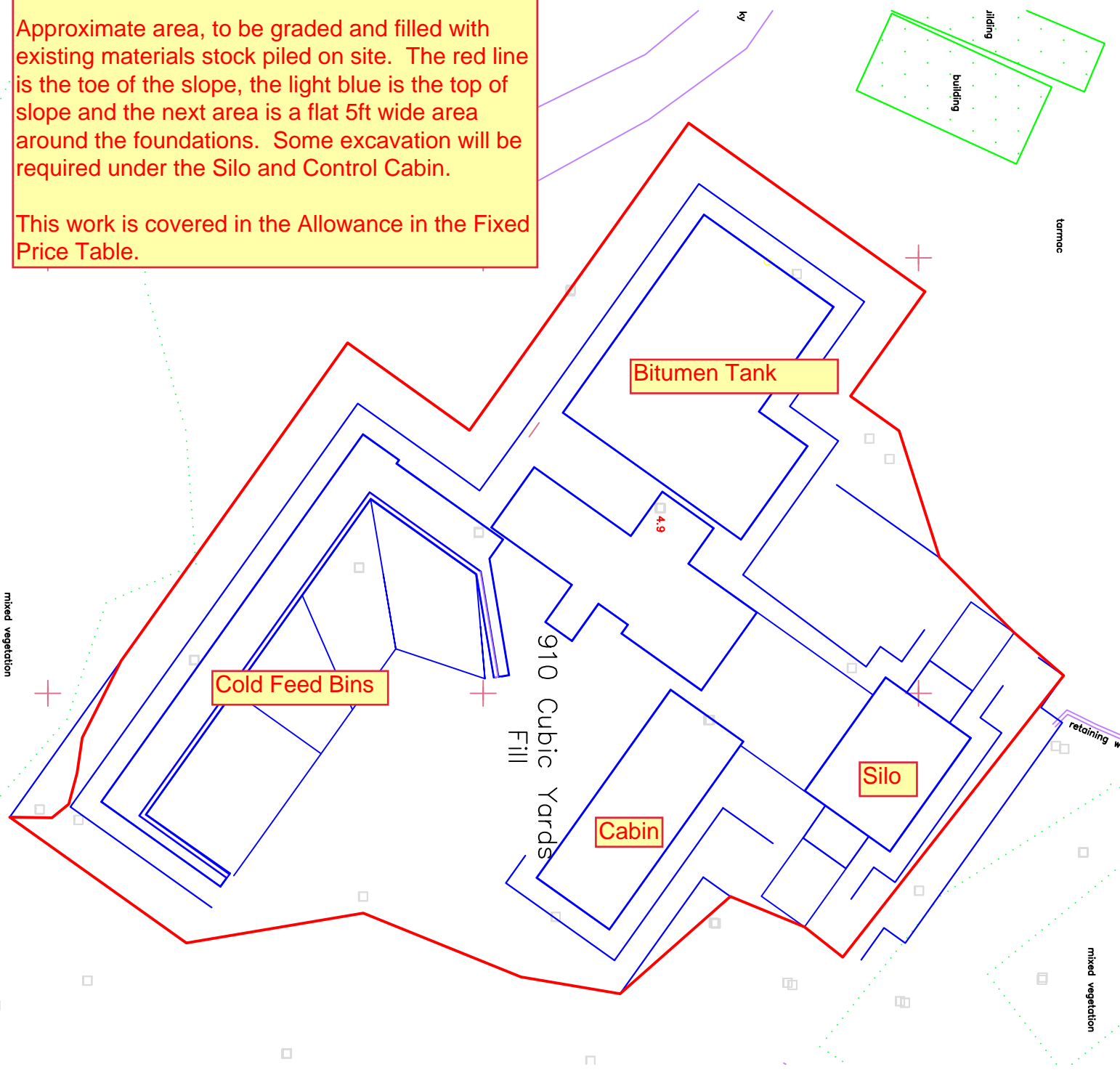

PRELIMINARY
NOT TO BE USED FOR CONSTRUCTION

REVISIONS			
No.	DATE	BY	REVISION
00	2024-08-27	RGW	ISSUED FOR PRELIMINARY PRICING

PROJECT DETAILS
PUBLIC WORKS QUARRY & DEPOT
QUARRY ROAD
HAMILTON PARISH
BERMUDA

TITLE
SCREENING PLANT
BUND WALL
STRUCTURAL DETAILS

DESIGN BY: JLS
CHECKED BY: RGW

JOB No:

DATE: 27-AUG-2024

REVISION: 0 SHEET No: S-303

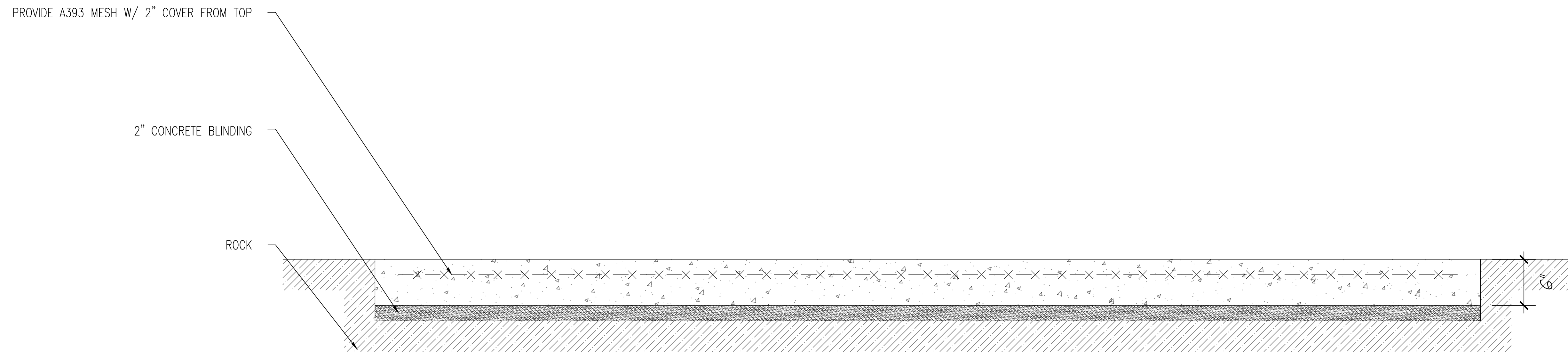

1 RELEASE AGENT SLAB SECTION
S-103 SCALE: 1-1/2" = 1'-0"

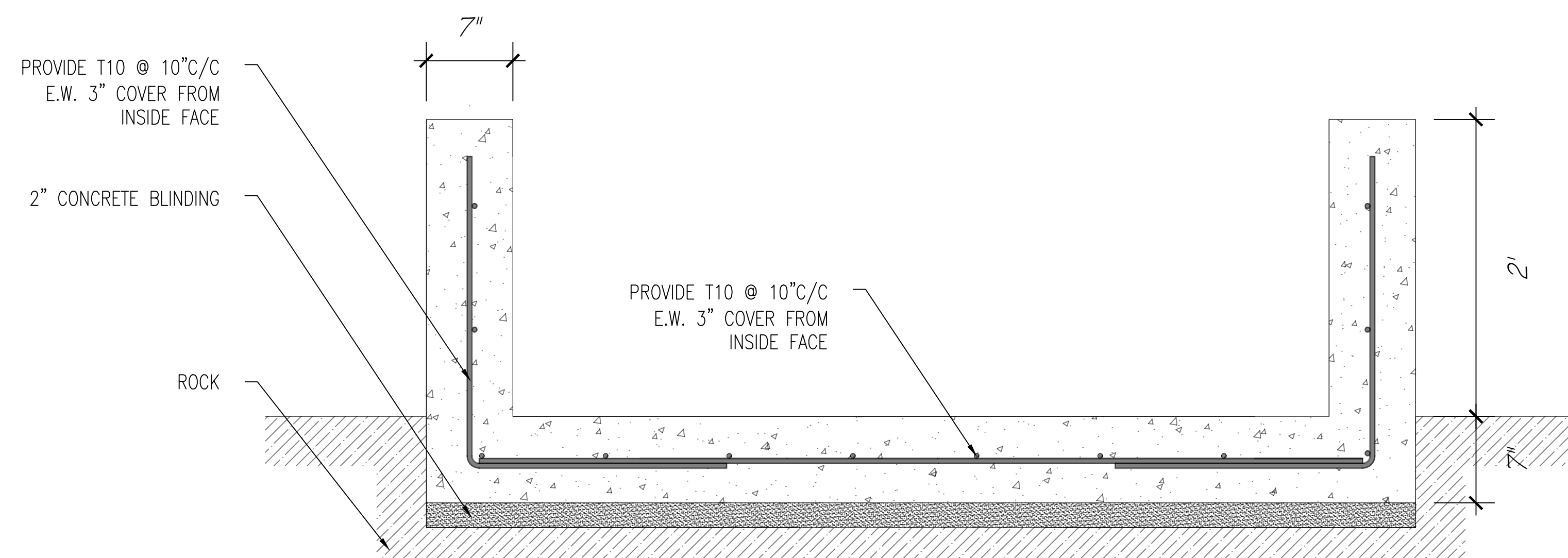

2 RELEASE AGENT BUND SECTION
S-103 SCALE: 1-1/2" = 1'-0"