

PROPOSED WALL DETAIL
VIEW A-A
1:10

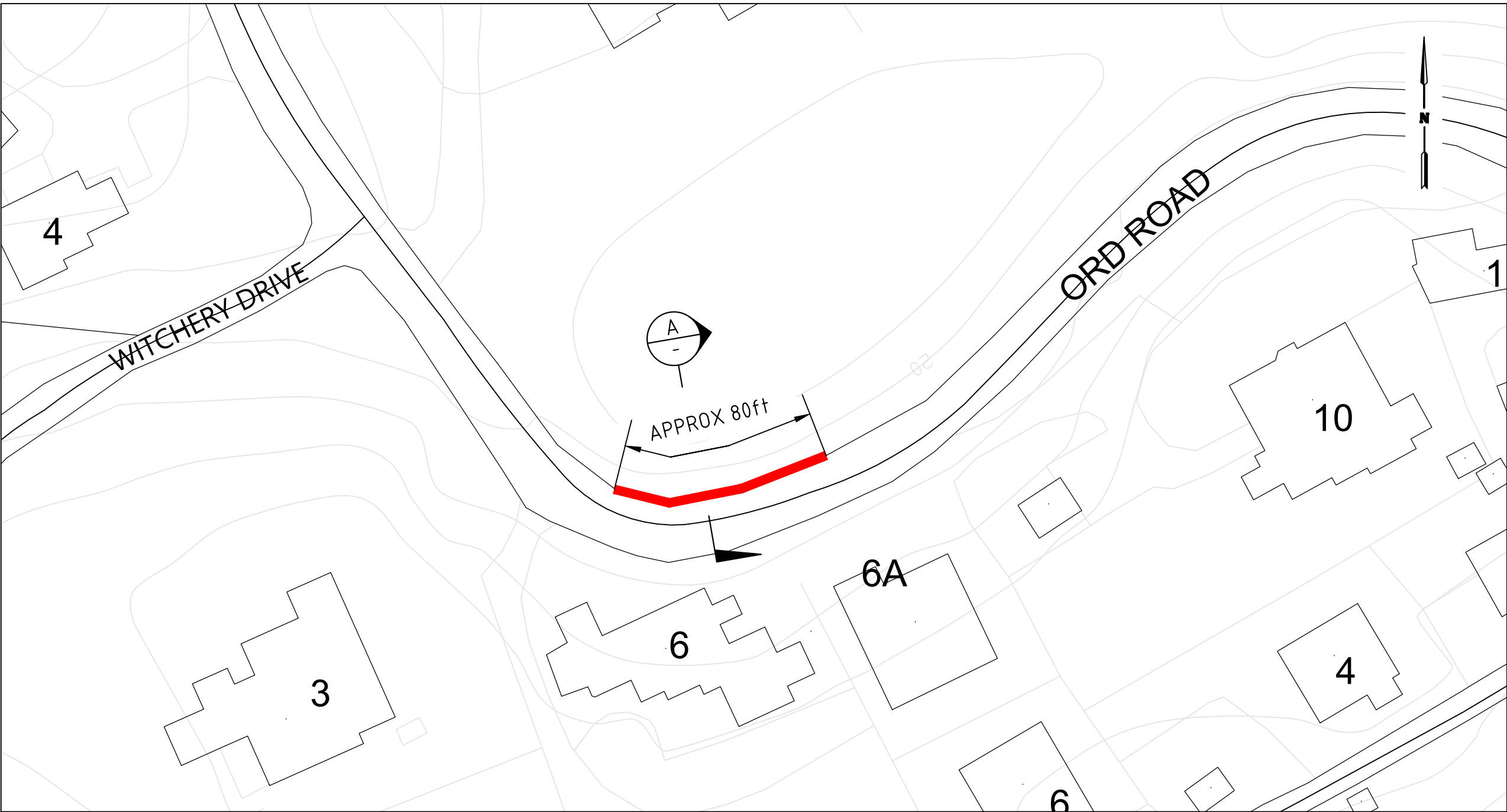

PLAN VIEW ON ORD ROAD
1:500

NOTES

1.0 FOUNDATIONS

- 1.1 FOUNDATIONS ARE TO BEAR ON UNDISTURBED GROUND OR ROCK. BEARING MATERIAL IS TO REMAIN UNDISTURBED AND BE REVIEWED BY THE ENGINEER PRIOR TO POURING FOOTING.
- 1.2 ANY SOFT AREAS IN ROCK ARE TO BE REMOVED AND FILLED WITH 20 MPa CONCRETE TO THE ENGINEER'S APPROVAL.

2.0 CONCRETE

- 2.1 ALL CONCRETE WORK IS TO BE IN ACCORDANCE WITH THE SPECIFICATIONS.
- 2.2 CONCRETE MIX DESIGNS TO BE SUBMITTED TO THE ENGINEER FOR APPROVAL.
- 2.3 CONCRETE PROPERTIES TO BE AS FOLLOWS:

LOCATION	MIN. SPECIFIED 28 DAY STRENGTH	SLUMP
FOOTINGS, BLOCK FILL	20 MPa (2900 PSI)	75 ± 20mm

- 2.4 CONCRETE COVER ON REINFORCING STEEL TO BE AS FOLLOWS:

LOCATION	CLEAR COVER
FOOTINGS	75 ± 20mm

- 2.5 REINFORCING CHAIRS TO BE PLASTIC OR CONCRETE.
- 2.6 NO ADDITIVES TO BE USED WITHOUT THE PRIOR APPROVAL OF THE ENGINEER.

3.0 REINFORCING STEEL

- 3.1 REINFORCING STEEL TO HAVE A MINIMUM YIELD STRENGTH OF 410 MPa, TYPE 2 DEFORMED TO BS4449.
- 3.2 REINFORCING STEEL TO BE GALVANISED IN ACCORDANCE WITH PART 1.1, SECTION 03200 OF THE SPECIFICATION.

4.0 INSPECTION AND TESTING

- 4.1 CONTRACTOR TO PROVIDE 24 HOURS NOTICE FOR THE INSPECTION OF ALL REINFORCING PRIOR TO POURING CONCRETE.
- 4.2 CONCRETE SHALL BE TESTED FOR SLUMP ON SITE. THE TEST CYLINDERS SHALL BE TAKEN FOR 3, 7 AND 28 DAY STRENGTHS. COMPRESSION TESTING SHALL BE CONDUCTED AT THE MINISTRY'S QUARRY TEST FACILITY.



PHOTO OF LOCATION OF ROADSIDE REPAIR

ISSUED FOR: TENDER

AMENDMENTS:

NO	REVISION	BY	APPL	DATE
A	FOR TENDER	CF	-	15/01/25

SCALE: AS SHOWN AT ANSI D

SURVEY
PREPARED BY: DATE:
.

DESIGN
PREPARED BY: DATE:
C FRASER 15/01/25
CHECKED BY: DATE:
.

DRAWING
PREPARED BY: DATE:
C FRASER 15/01/25
CHECKED BY: DATE:
.

APPROVED BY: DATE:
.

PROJECT NUMBER:

PROJECT NAME:

ORD ROAD
ROAD NEAR No. 7
ROADSIDE WALL

WARWICK

SHEET TITLE:
GENERAL ARRANGEMENT
AND DETAILS

SHEET NUMBER:	REVISION
S001	A