

AMENDMENTS:

NO	REVISION	BY	APP	DATE

Ⓜ Pump Panel relocated
Ⓜ Fence Removed

SCALE: AS SHOWN

SURVEY

PREPARED BY: DATE: .

DESIGN

PREPARED BY: DATE: .

CHECKED BY:

DATE: .

DRAWING

PREPARED BY: DATE: .

CHECKED BY:

DATE: .

APPROVED BY:

DATE: .

PROJECT NUMBER:

PROJECT NAME:

FORT PROSPECT
CENTRAL AREA
PUMP STATION
Fort Hill Road

Devonshire

SHEET TITLE:

Plans
& Sections

SHEET NUMBER:

FP02

REVISION

B

NOTES

1.0 FOUNDATIONS

1.1 ALL FOUNDATIONS TO BEAR ON COMPACTED BEARING MATERIAL WHICH IS TO BE REVIEWED BY THE ENGINEER PRIOR TO PLACING FOUNDATIONS.

1.2 ANY SOFT AREAS ARE TO BE REMOVED AND FILLED WITH CONCRETE FILL TO THE ENGINEER'S APPROVAL.

2.0 CONCRETE

2.1 CONCRETE TO BE MINIMUM 25 MPa STRENGTH WITH 3 in +/- 1 in, SLUMP

2.2 CONCRETE COVER ON REINFORCEMENT TO BE 2 in.

2.3 THE CONTRACTOR SHALL GIVE A MINIMUM OF 24 HOURS NOTICE TO THE ENGINEER PRIOR TO PLACING ANY CONCRETE.

3.0 REINFORCING STEEL AND MESH

3.1 REINFORCEMENT SHALL BE GRADE 400 DEFORMED BILLET STEEL WITH A MINIMUM YIELD STRENGTH OF 400 MPa.

3.2 REINFORCEMENT TO BE GALVANISED

3.3 REINFORCEMENT WHICH IS CUT AND BENT ON SITE SHALL HAVE TWO APPLICATIONS OF A "ZINC" RICH PAINT APPLIED TO THE ENDS AND DAMAGED AREAS TO THE APPROVAL OF THE ENGINEER.

4.0 FLOOR FINISH

4.1 FLOOR SURFACE TO RECEIVE A STEEL TROWEL FINISH

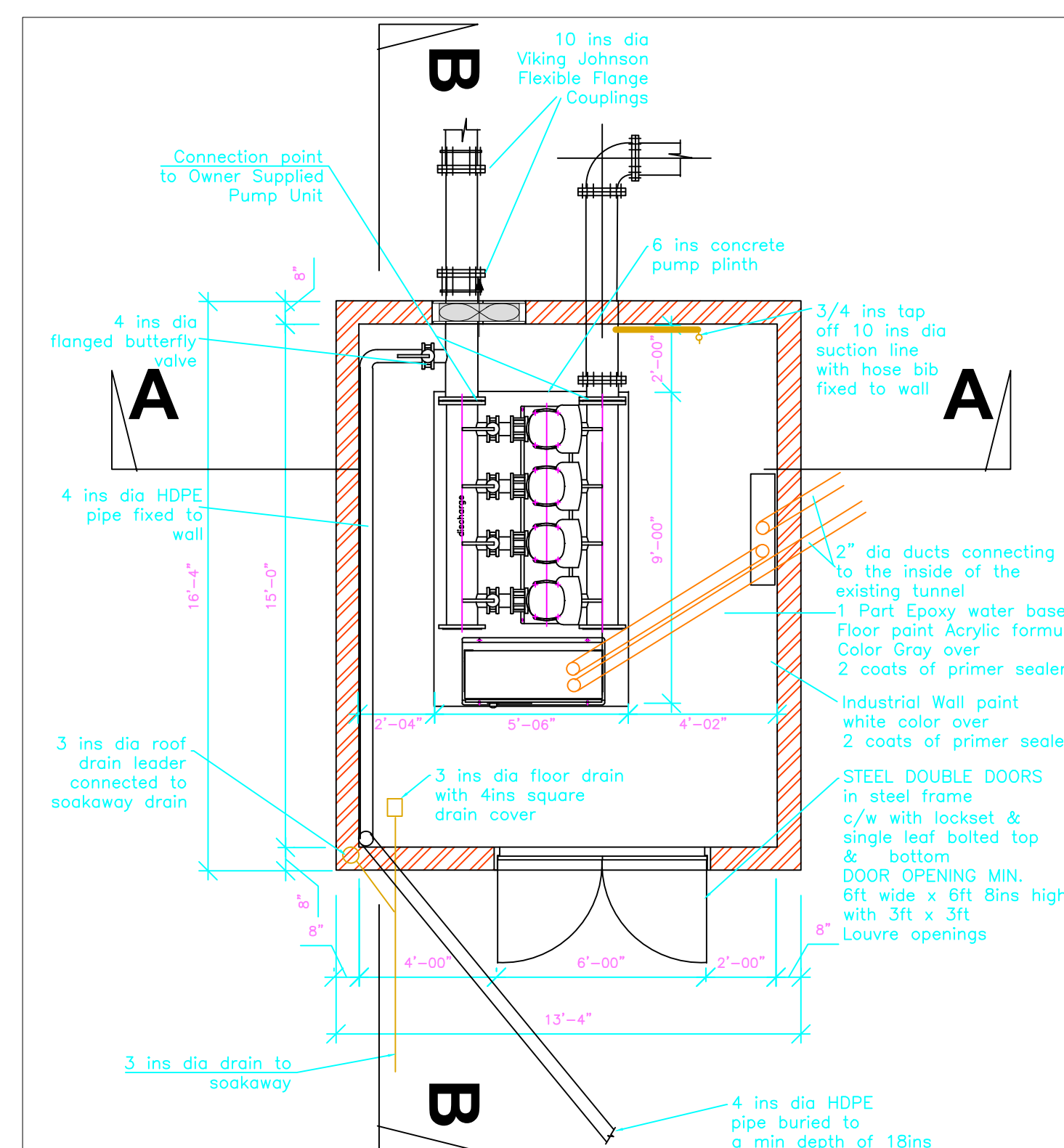

FLOOR PLAN
1/4" = 1'-0"

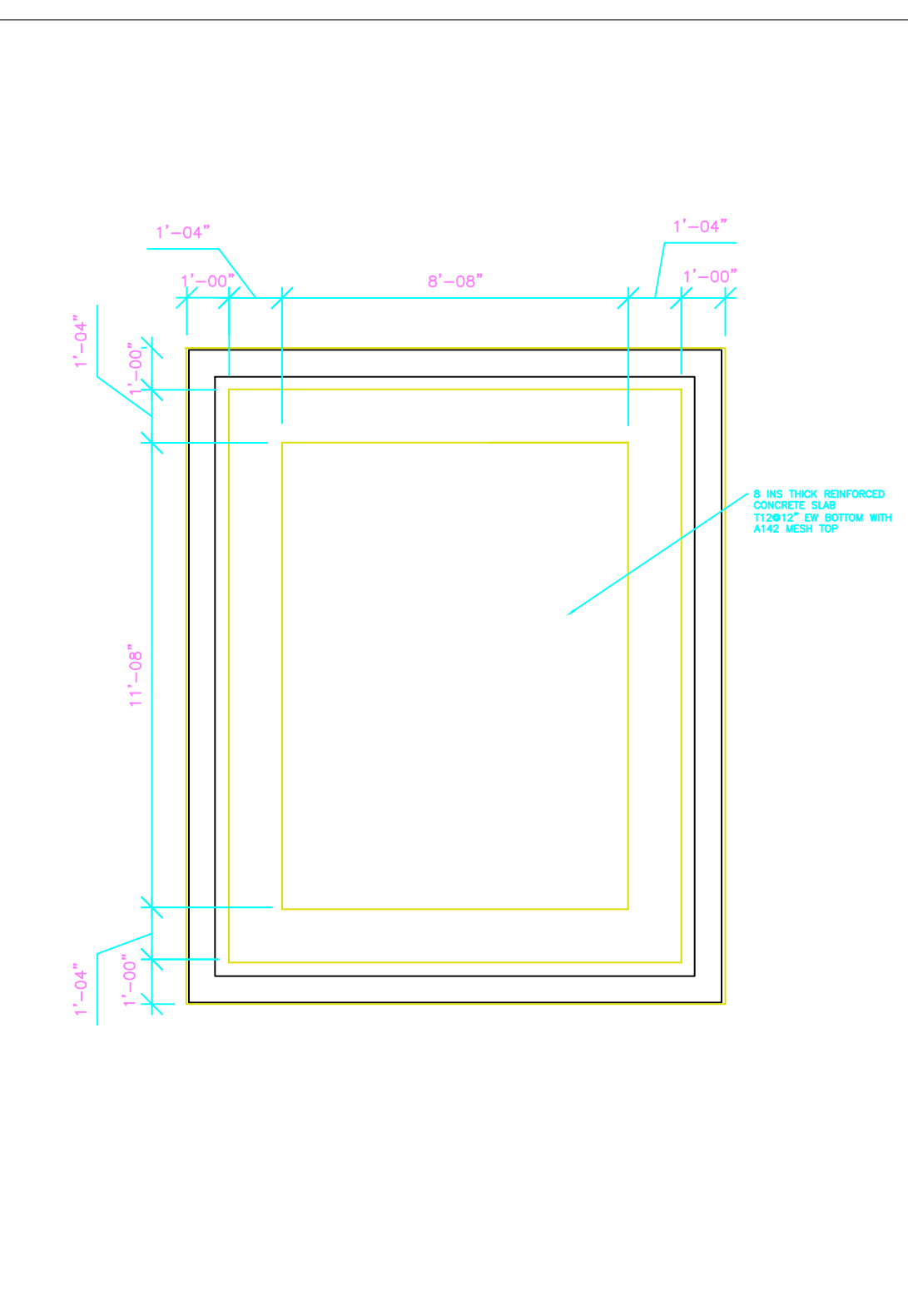

FOUNDATION PLAN
1/4" = 1'-0"

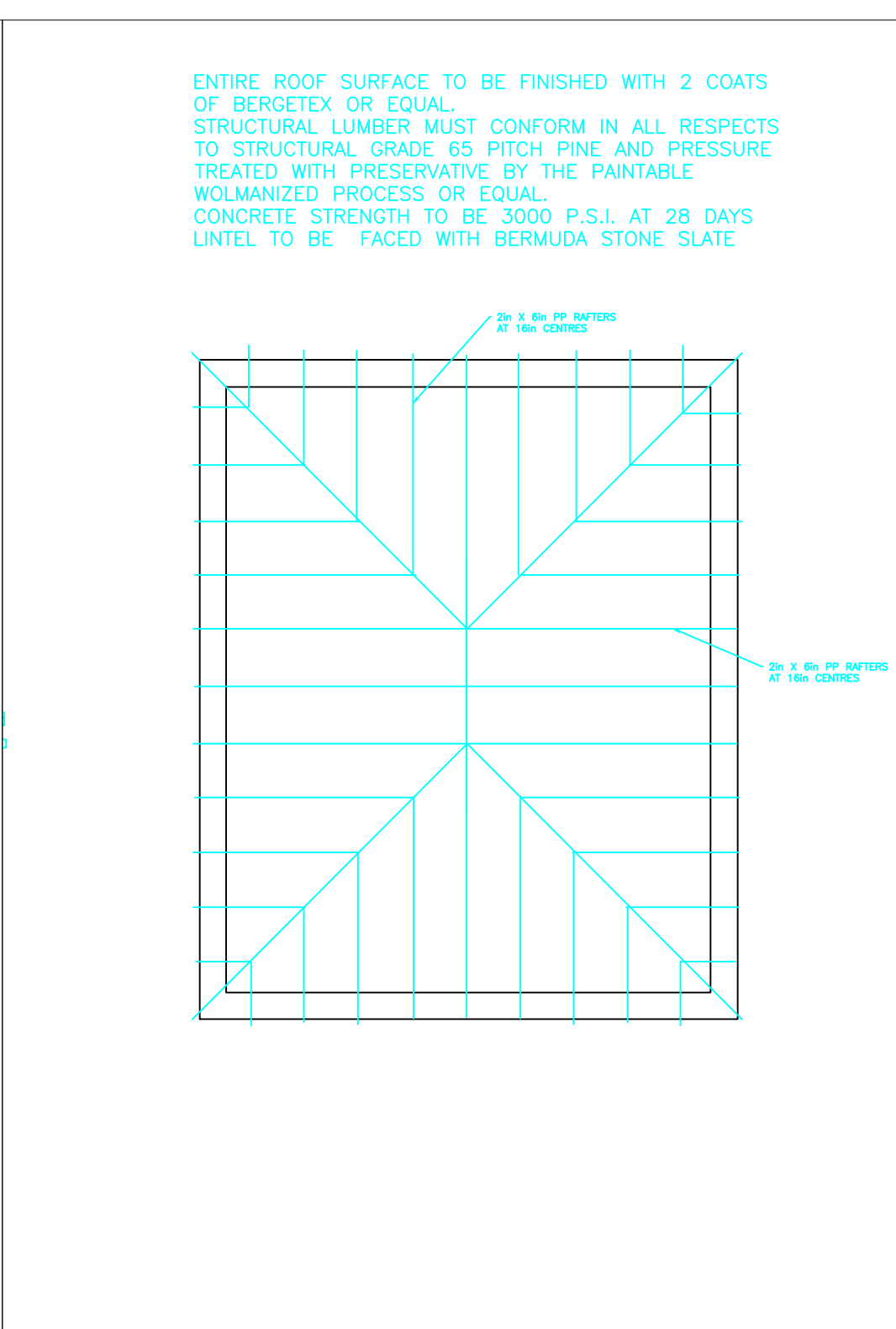

ROOF PLAN
1/4" = 1'-0"

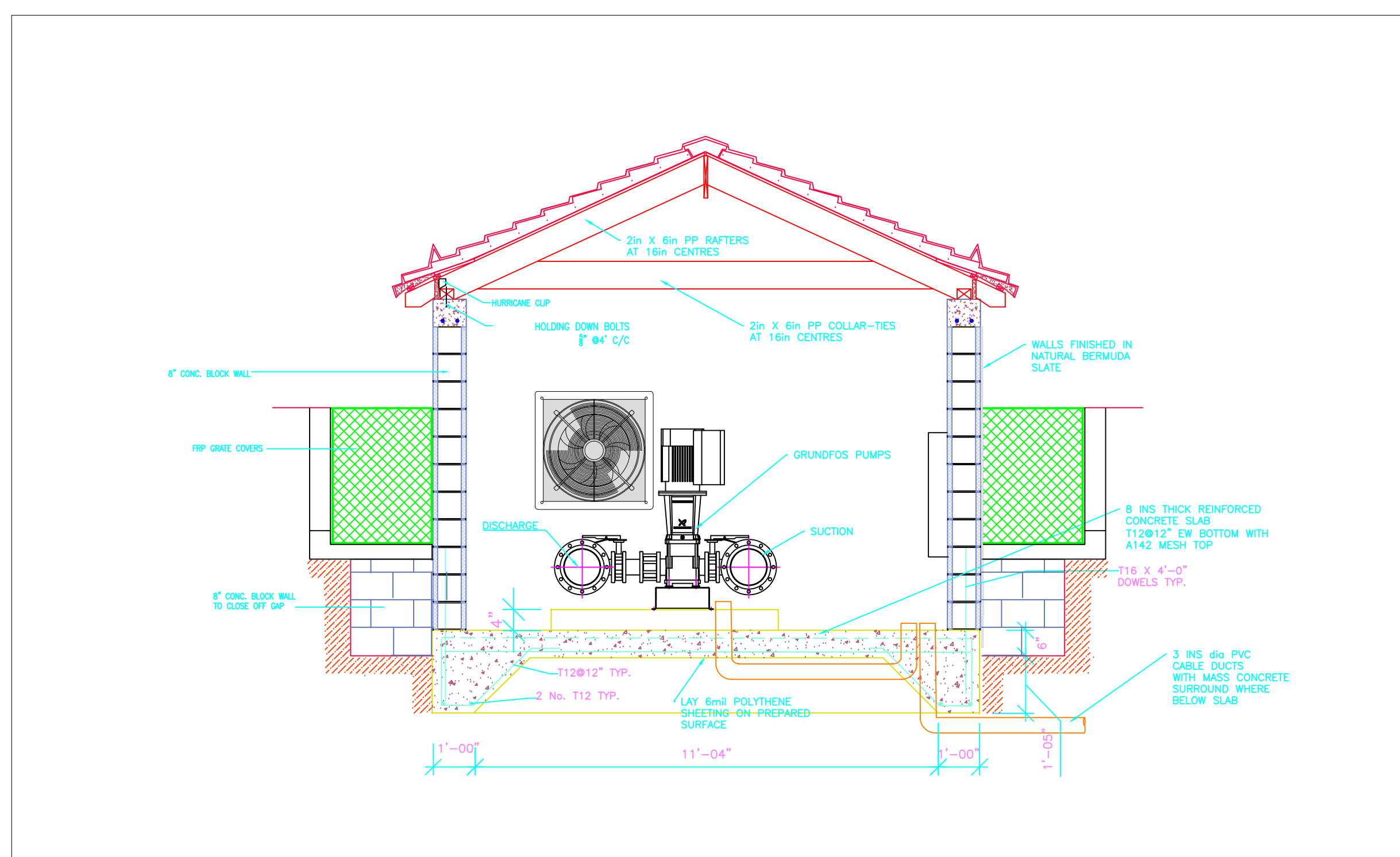

SECTION A-A
3/8" = 1'-0"

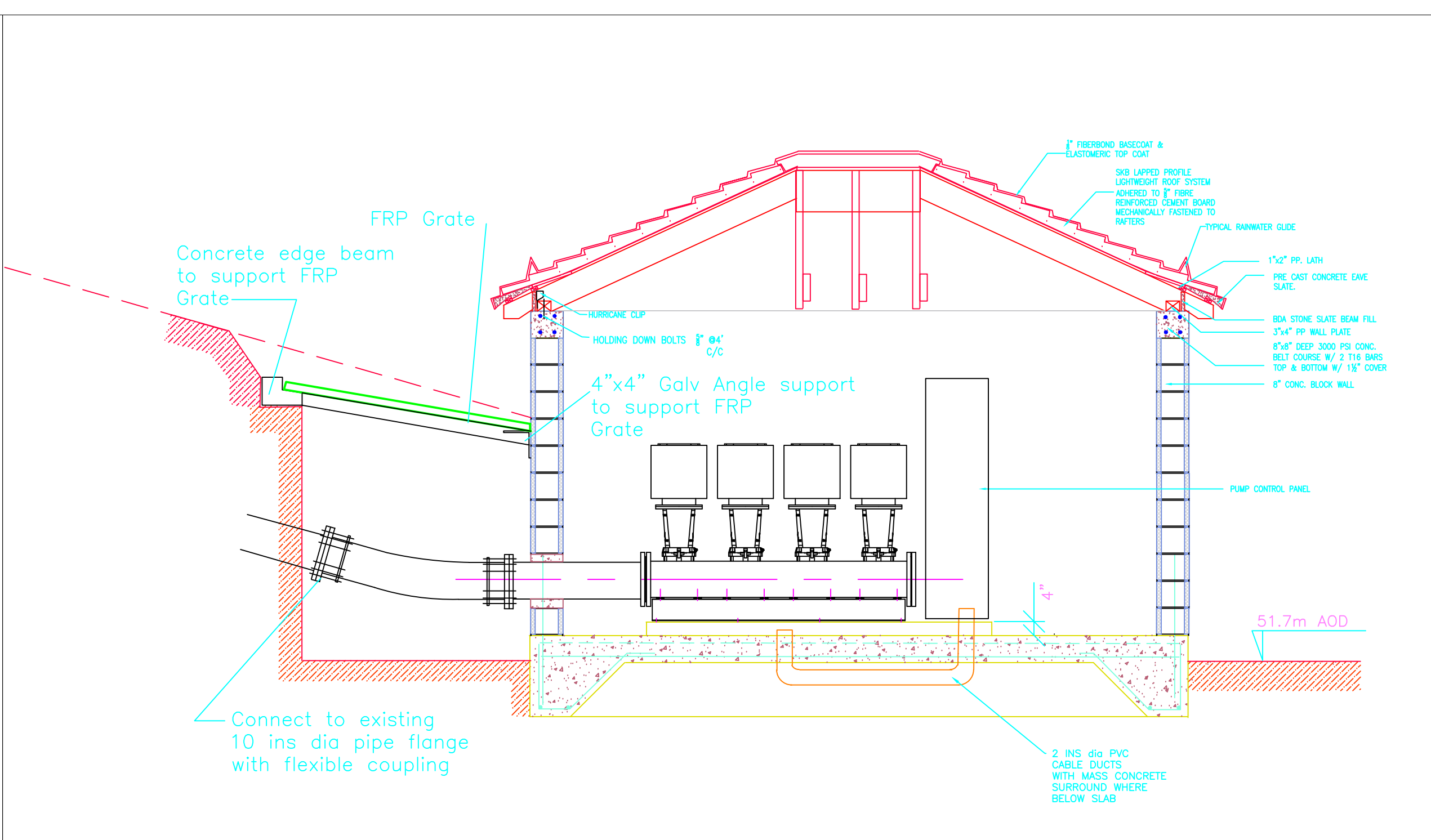

SECTION B-B
3/8" = 1'-0"